

Anteater Learning Pavilion

Info Session for Schedule of Classes Coordinators

Mathew Williams
Division of Teaching
Excellence and Innovation

Andrea Aebersold
Division of Teaching
Excellence and Innovation

Eric Rupp
OIT Classroom
Technology Support

Where It All Began: SE101



Growth in ALCs

| | | 2016-2017 | 2017-2018 | 2018-2019 |
|--------------------------------------|-------------------|-----------|-----------|-----------|
| Active Learning | Rooms | 1 | | |
| Classrooms w/ Enhanced Technology | Seats | 56 | | |
| | Max. Courses/Term | 23 | | |

Retrofitted Spaces



PSCB 140



AIRB 1030

Retrofitted Spaces



SST 220B



SST 220A

Growth in ALCs

| | | 2016-2017 | 2017-2018 | 2018-2019 |
|---|-------------------|-----------|-----------|-----------|
| Active Learning Classrooms w/ Enhanced Technology | Rooms | 1 | 1 | |
| | Seats | 56 | 56 | |
| | Max. Courses/Term | 23 | 23 | |
| Active Learning Classrooms w/ Standard Technology | Rooms | | 4 | |
| | Seats | | 232 | |
| | Max. Courses/Term | | 92 | |









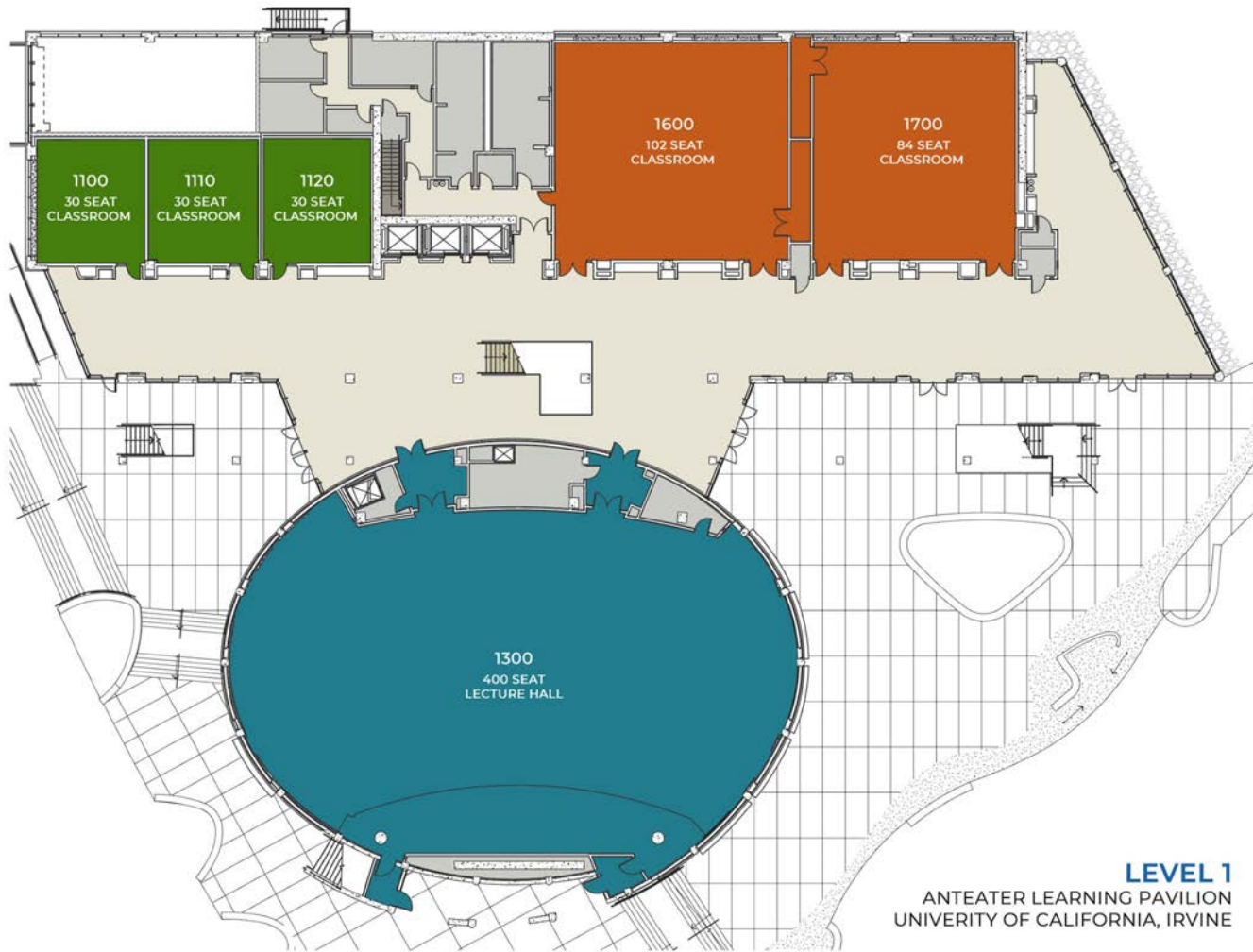

LEVEL 1
ANTEATER LEARNING PAVILION
UNIVERSITY OF CALIFORNIA, IRVINE

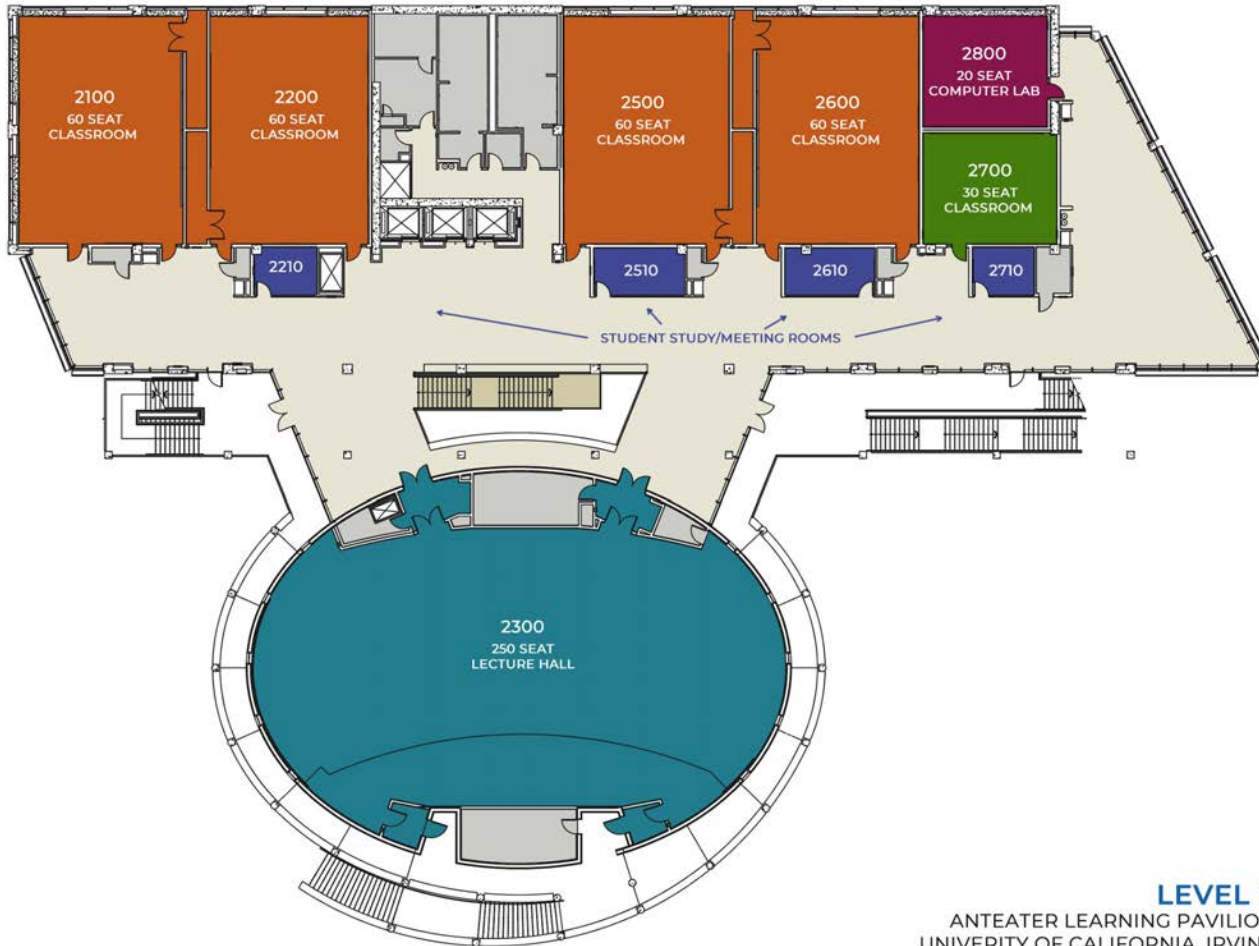

LEVEL 2
ANTEATER LEARNING PAVILION
UNIVERSITY OF CALIFORNIA, IRVINE

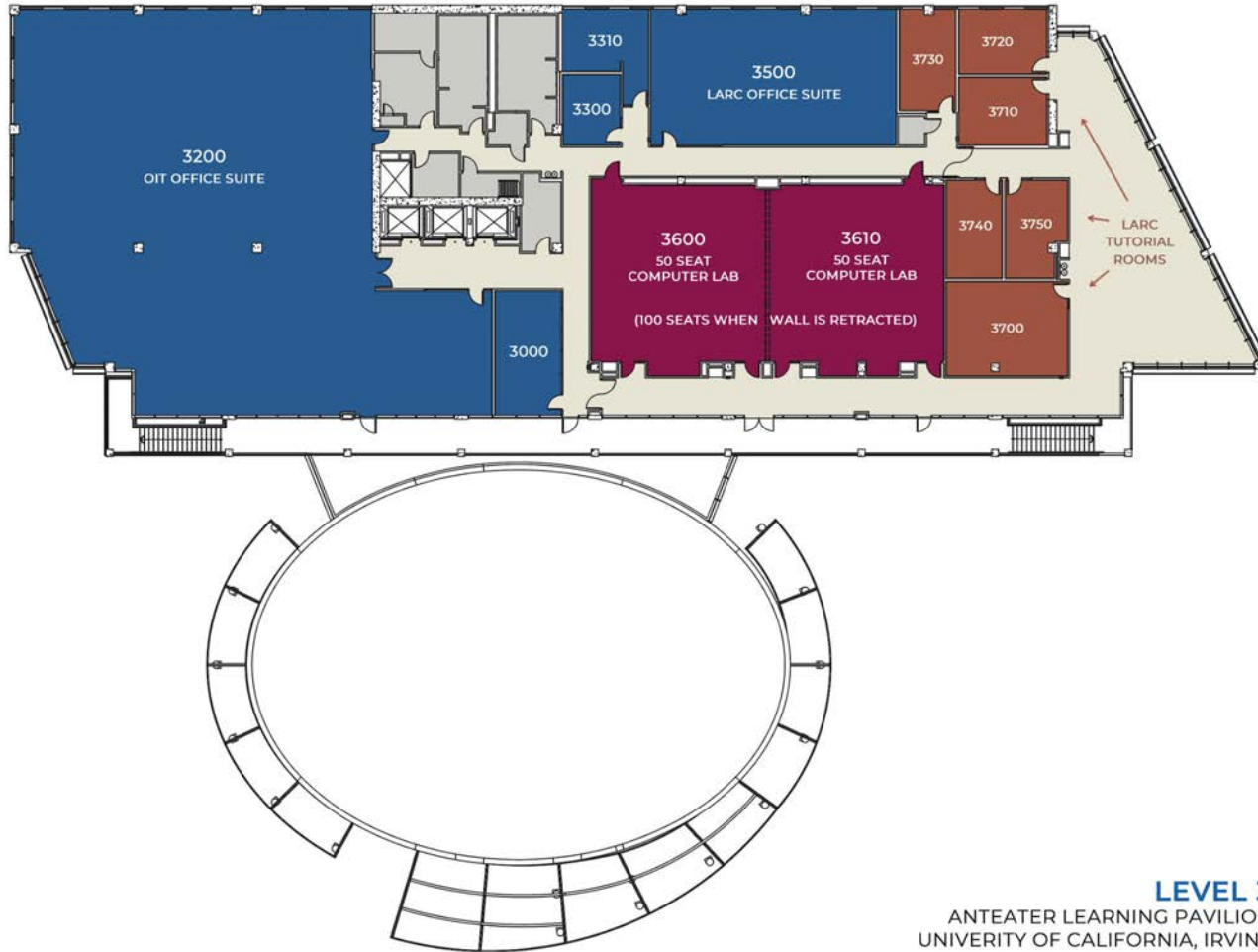

LEVEL 3
ANTEATER LEARNING PAVILION
UNIVERSITY OF CALIFORNIA, IRVINE

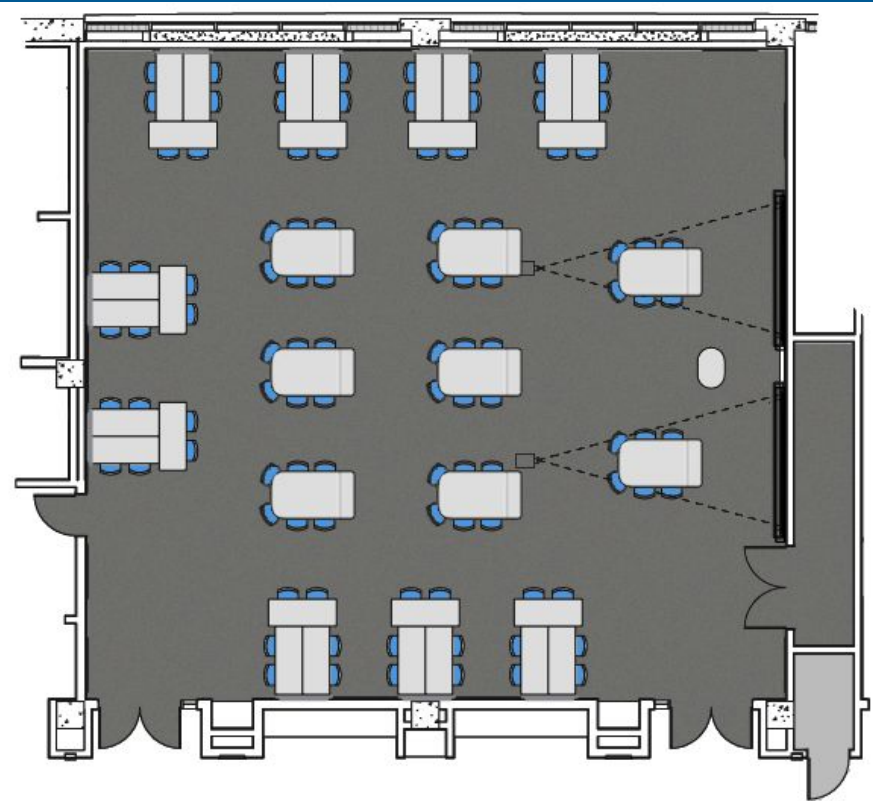

1600

102 SEAT CLASSROOM
ANTEATER LEARNING PAVILION
UNIVERSITY OF CALIFORNIA, IRVINE





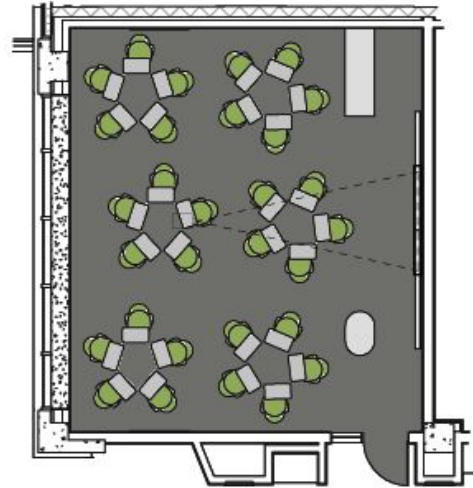
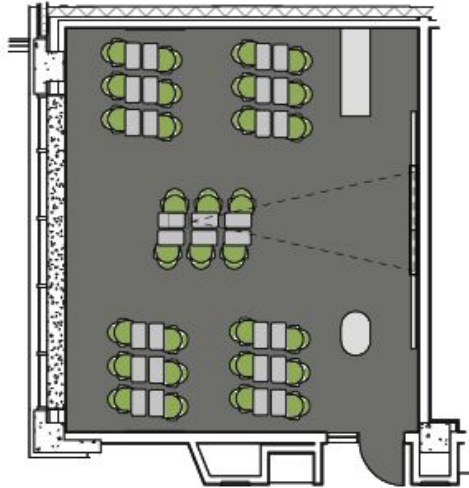
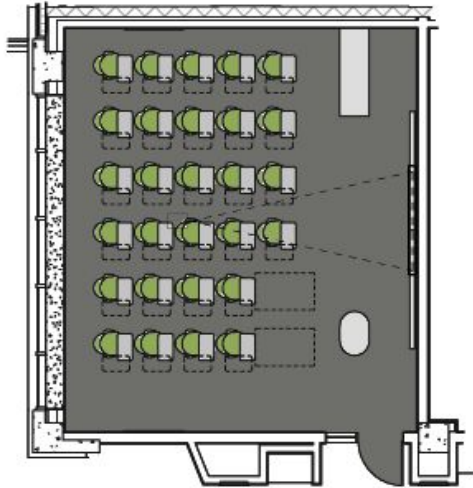

1100
30 SEAT CLASSROOM
ANTEATER LEARNING PAVILION
UNIVERSITY OF CALIFORNIA, IRVINE



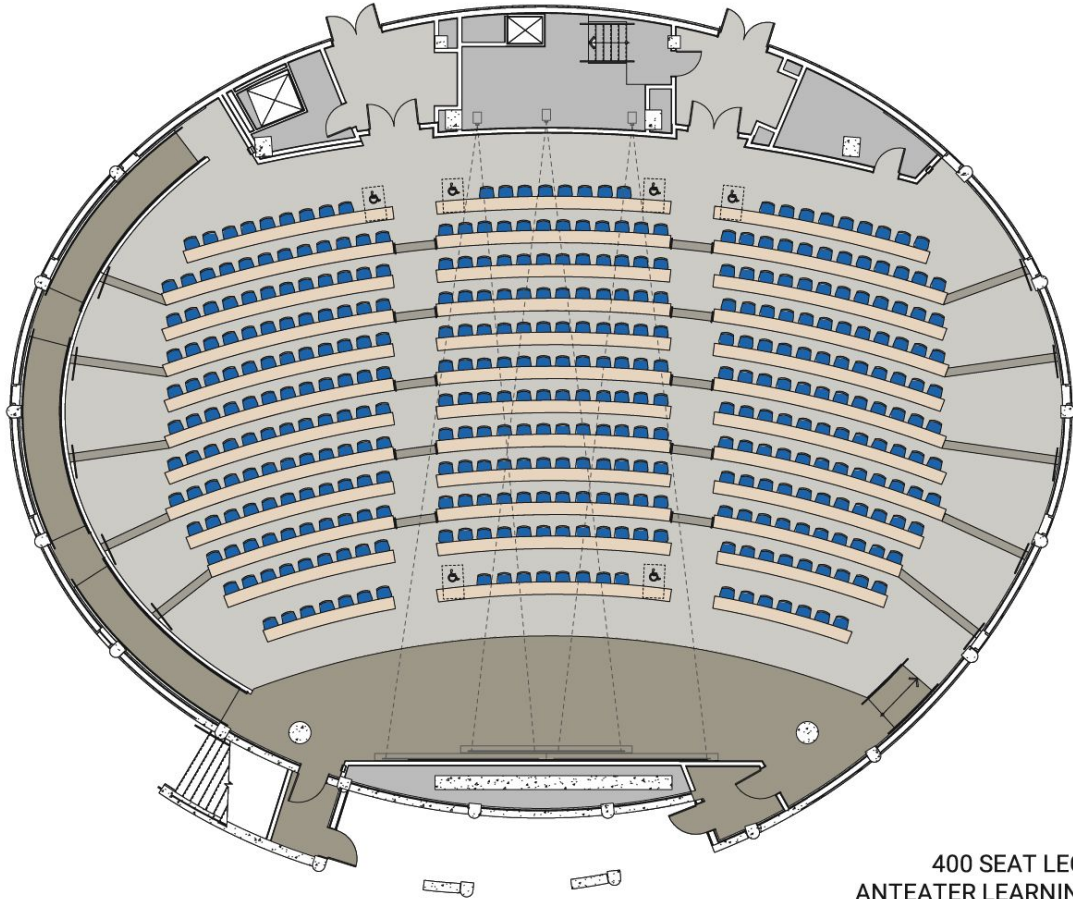

1300
400 SEAT LECTURE HALL
ANTEATER LEARNING PAVILION
UNIVERSITY OF CALIFORNIA, IRVINE





Informal Learning Spaces

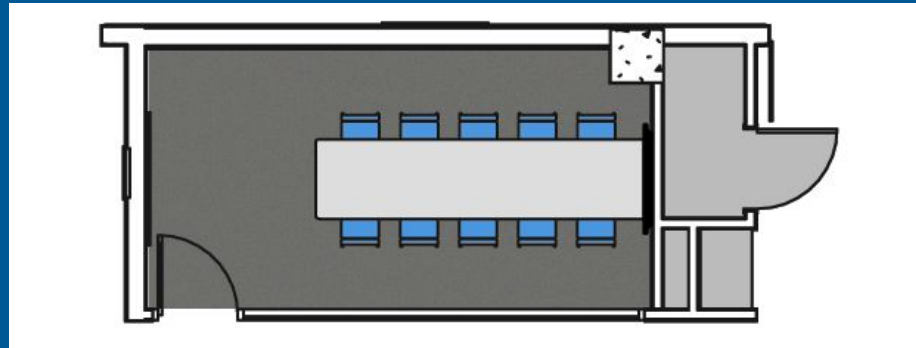

Growth in ALCs

| | | 2016-2017 | 2017-2018 | 2018-2019 |
|---|-------------------|-----------|-----------|-----------|
| Active Learning Classrooms w/ Enhanced Technology | Rooms | 1 | 1 | 6 |
| | Seats | 56 | 56 | 422 |
| | Max. Courses/Term | 23 | 23 | 138 |
| Active Learning Classrooms w/ Standard Technology | Rooms | | 4 | 9 |
| | Seats | | 232 | 412 |
| | Max. Courses/Term | | 92 | 207 |
| Active Learning Lecture Halls | Rooms | | | 2 |
| | Seats | | | 650 |
| | Max. Courses/Term | | | 46 |

Design and
Construction

Faculty Outreach,
Development, and
Training

Student Outreach
and Training

Course Scheduling

Support

Evaluation

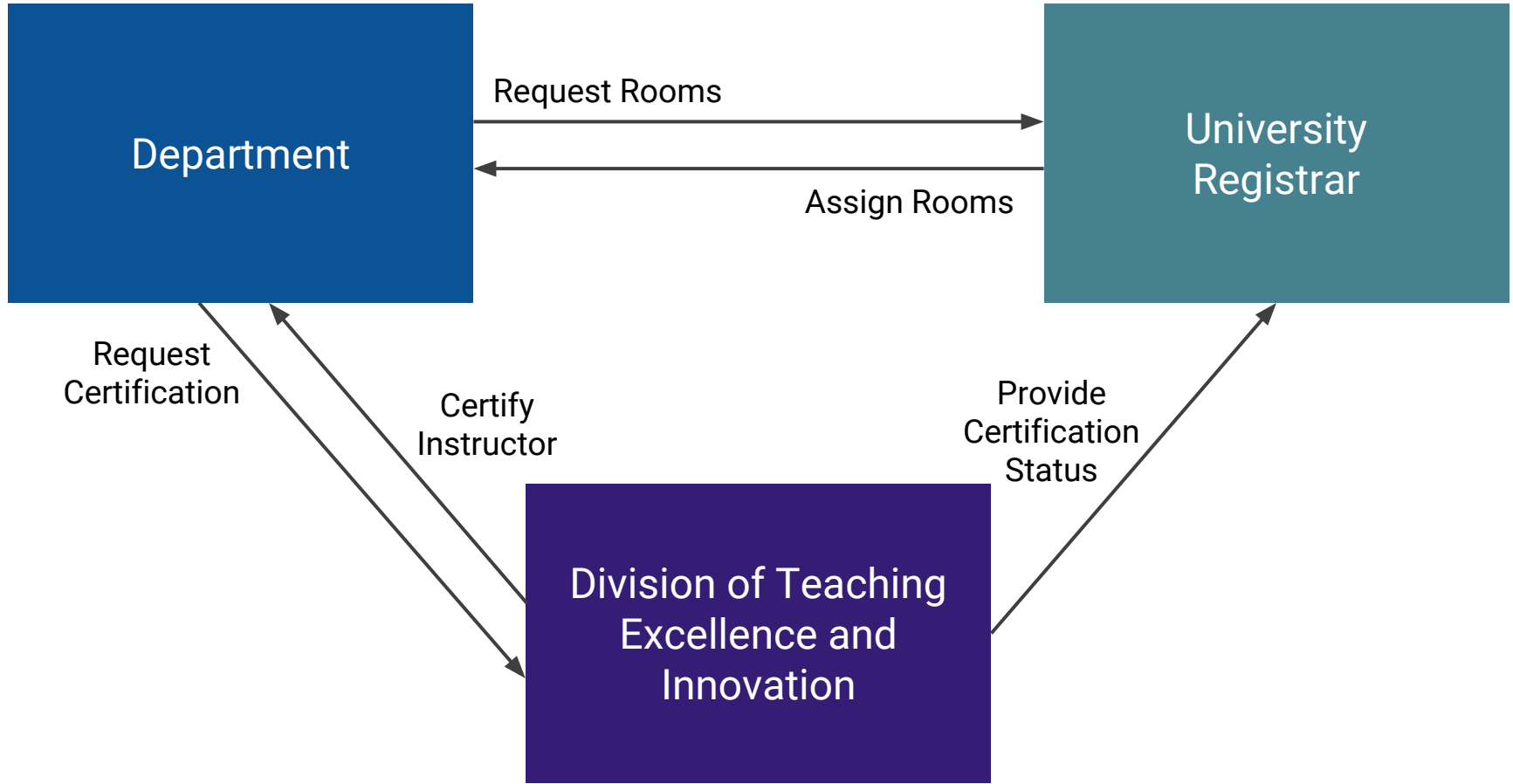

Active Learning Certification

Two options:

- Active Learning Institute
- DTEI Consultation and Observation

To get started, faculty should:

- Complete the interest form
anteaterlearningpavilion.ovptl.uci.edu/scheduling/
- Or, contact DTEI
dteidevelop@uci.edu

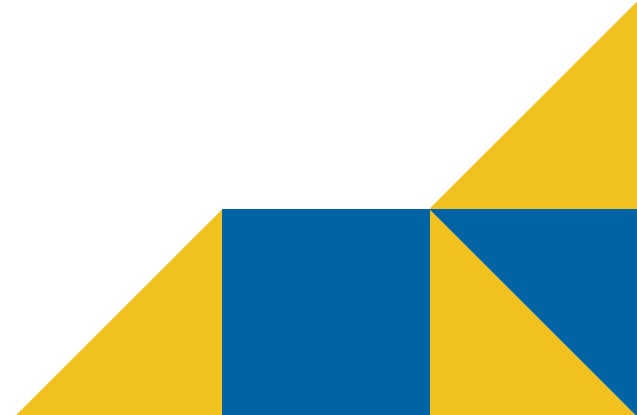

Important Notes on Scheduling

Room requests should be submitted before first deadline for full consideration

Other priority criteria will still apply

Instructors do not need to be certified prior to room assignments, but do need to have selected a certification option

Not all Active Learning Classrooms are designated for priority scheduling

See: anteaterlearningpavilion.ovptl.uci.edu/details/classroom-comparison/

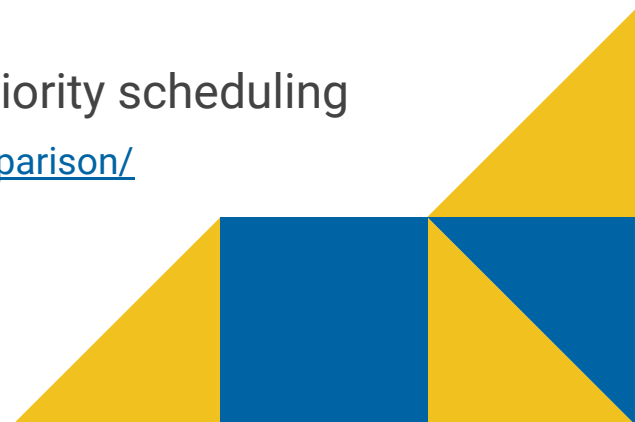

Resources

ALP Website anteaterlearningpavilion.ovptl.uci.edu/

OIT CTS Website classrooms.uci.edu/

DTEI Website dtei.uci.edu/learning-environments/

Registrar Website reg.uci.edu



Q&A

Mathew Williams

Division of Teaching
Excellence and Innovation

Andrea Aebersold

Division of Teaching
Excellence and Innovation

Eric Rupp

OIT Classroom
Technology Support

Paul Lampano

University Registrar

Priscilla Nguyen

University Registrar